

CombiStar 7250

Electronic lock **CombiStar 7250** with manually operated bolt motion

EN 1300
VdS
class 2/B



From  Bishopsgate

WITTKOPP
High-security locks
cawi

INSYS
MICROELECTRONICS

Solutions for higher security

Electronic lock CombiStar 7250 pro

Index

CombiStar „pro“(fessional)

Applications	3
Features	3
Master combination entitlements	4
User combination entitlements	4
Operation	5
Programming	5
Programming by PC	6
Audit trail	7
Input/output functions	8
CombiXT	9
Installation-detail-screen	9
Technical specifications	10
Accessories	10
CombiStar „simplex“	11

From



Bishopsgate



Electronic lock CombiStar 7250 pro

Applications

The CombiStar 7250 electronic locks are deadlatch bolts in standard dimensions used, for example, in boltworks (locking mechanism). Locked bolt will be cleared by switching motor after safety inspection. The bolt motion can be operated by turning key pad.

The lock can be applied just everywhere you want to operate comfortable.

- safes
key safes
gun safes
data-/ fire protection safes
ATM's
- for initial equipment or for re-fitting (replacement of mechanical combination locks)

Properties

- 1 Master- and 9 User-Codes
- Dual user mode
- Event memory (the last 256 operational inputs including time and date are stored)
- Timed opening delay (1 to 99 min)
- individual time programs
- self-adapting summer-/winter time
- Duress Alarm
- Remote blocking
- Open-/ Close-signal
- Connectable with alarm systems
- Mains operation possible
- Certification as per EN 1300, Class B, or VdS, Class 2

From



Bishopgate



Solutions for higher security

Electronic lock CombiStar 7250 pro

Master combination entitlements

- Activating and deactivating users
- Activating and deactivating the timed delay period
- Allocating fasten opening code
- Activating and deactivating the duality (interlock) feature
- Setting up of time zones and allocated users
- Setting up the input and output functions
- Readout of audit trail and writing the journal
- Opening and closing
- Changing the master combination
- Programming by PC

User entitlements

- Opening and closing
- Changing one's own combination

From  Bishopsgate

 
Solutions for higher security

Electronic lock CombiStar 7250 pro

Operation

The basic functions for the CombiStar 7250 electronic locks are very easy to use.

CombiStar 7250 pro	
Open	Select user number (1 digit) Enter combination (6 digits) Key pad turning in opening position
Close	Key pad turning in closing position

Programming

Programming the CombiStar 7250 electronic locks is quite simple. Most functions are programmed with the lock open.

The following structure is used for programming:

*** Digit * Combination * Number * [Number *]**

This means:

Digit: Corresponding to the desired program function
Combination: Master or user combination
Number: Sub-function, value or new combination

Example: Reprogram combination

* 1 * Old combination * New combination * New combination *

* 1 * 123456 * 734829 * 734829 *

From



Bishopsgate



Solutions for higher security

Electronic lock CombiStar 7250 pro

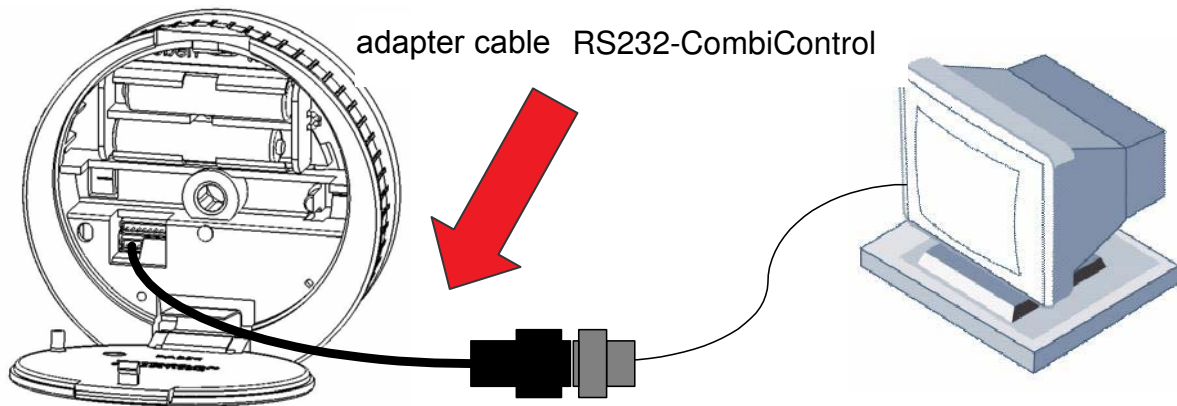

Programming by PC

The programming by PC will be made by **parameterising set CombiComm**.
Following settings by PC can be programmed:

- Time programs
- Dual user mode
- IO-Funktionen
- Direct access code
- Time delay / Opening delay
- Date/Time

Audit trail

The last 256 events will be journalised chronological with date and time. The readout of events goes also by **parameterising set CombiComm**.

Electronic lock CombiStar 7250 pro

Following events will be journalised

lock opened	electronic lock has been opened
lock closed	electronic lock has been closed
entering code	entrance code has been operated
reboot	the lock system has been rebooted
programming PC	scanning and programming by software has been operated
programming code	code has been operated
delete code	user code has been deleted
dual user mode	dual user mode activated/deactivated
time delay	time delay has been programmed
duress alarm	duress alarm has been activated
attack	attack, top cover has been opened
blocking time	lock has been blocked
release time	release time has been programmed
date/time	date/time has been programmed
IO-functions	IO-functions has been programmed

Electronic lock CombiStar 7250 pro

Input and output functions

The CombiStar 7250 electronic locks are distinguished by versatile input and output functions. This facilitates integration with other systems such as alarm systems.

The following input signals can be processed:

- The lock can be released or blocked by closing or opening a contact (deadlatch bolt function).

The lock can make available the following output signals:

- Bolt blocked / not blocked
- Signal for silent alarm
- End of the timed opening delay period

The functions involving input and output signals can also be easily programmed, following the general programming principle.

The signals are available at the sockets on the locks. A „CombiXT“ junction box is available as an accessory to facilitate making the connection. An external power supply can also be connected via the CombiXT.

From  Bishopsgate

 
Solutions for higher security

Electronic lock CombiStar 7250 pro

CombiXT

The blocking device CombiXT is the connection between the lock and the alarm system. Following input/output-signals can readout by CombiXT.

- release / blocking
- Duress alarm
- switch bolt position

Installation-detail-screen

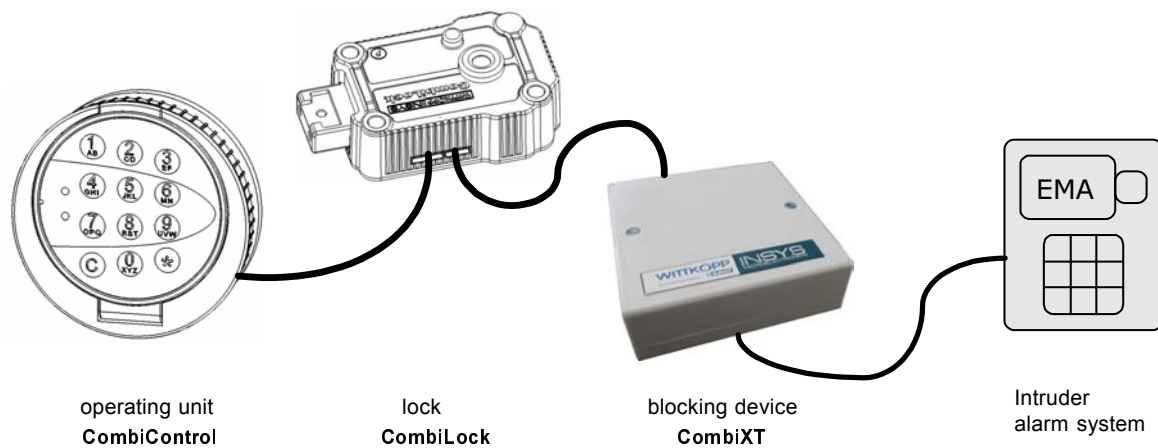

Electronic lock CombiStar „pro“

Technical specifications

Screw pattern	standard
Bolt extension	9 oder 15mm
Battery power supply 2 batteries AAA	2 x 1,5 V
Power supply with wall transformer with CombiXT	12V, 500 mA
Power drawn in sleep mode (with keypad) „pro“	approx. 5 μ A
Power drawn in sleep mode (with keypad) „simplex“	approx. 2 μ A
Ambient temperature	0 bis 50° C
Ambient relative humidity	bis 75%

Stand Januar 2006
technische Änderungen vorbehalten

Accessories

- Connection box CombiXT
- PC-Software CombiComm (for readout of event memory)



Electronic lock CombiStar „simplex“

CombiStar „simplex“

The basic version CombiStar“simplex“ is a replacement for a mechanical combination lock, if you go without the electrical comforts.g. time functions of the version „pro“. In addition to the blocking time in case of faulty insertion and the battery monitoring, this version concerns the following features:

- 2 Usercodes
- Time delay (1 bis 99 min)

Operation

CombiStar 7250 simplex	
Open	Enter combination (6 digits) Key pad turning in opening position
Close	Key pad turning in closing position

seit 1857

Tradition und Innovation

**in der Herstellung von
Hochsicherheitsschlössern**

since 1857

Tradition and Innovation

**for the production of
high security locks**



Bishopsgate Int (Nig) Ltd
52a Campbell Street
Lagos Island CBD
Lagos State 100221

Tel. **+234 (700) 247-4677-4283**

Email: sales@bishopsgate-nq.com

Web: www.bishopsgate-nq.com